

KEYNOTES

- 1 TWO LAYERS OF 1/2" FIRE RATED GYPSUM BOARD ON THIS SIDE OF THIS WALL ON SECOND FLOOR ONLY.
- 2 1" FIRE RATED GYPSUM BOARD ON INSIDE OF HOISTWAY.

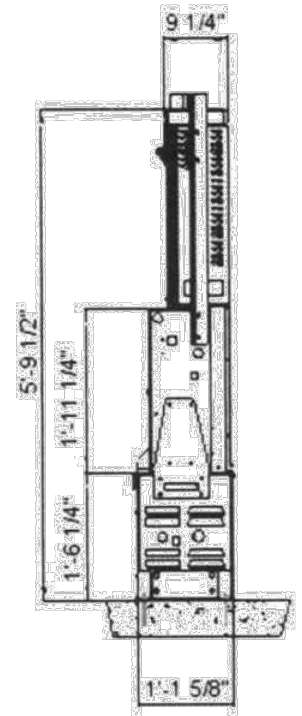
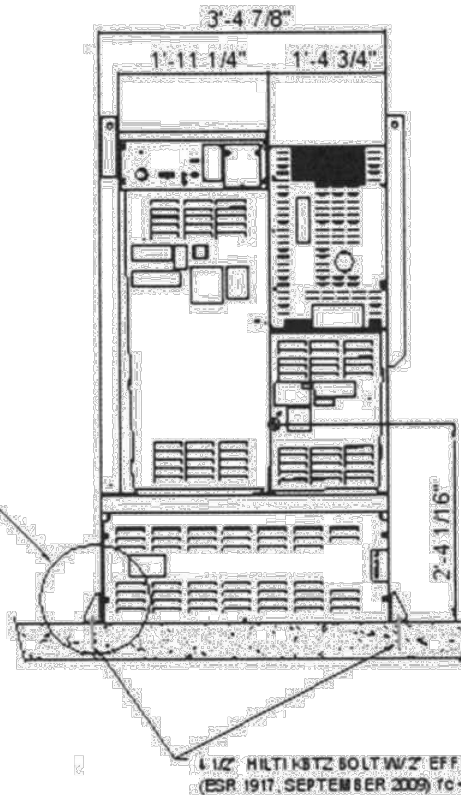
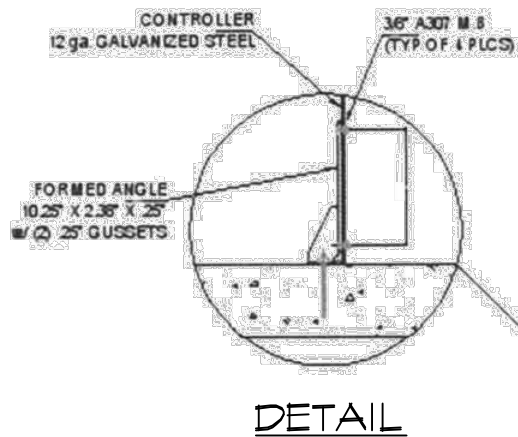
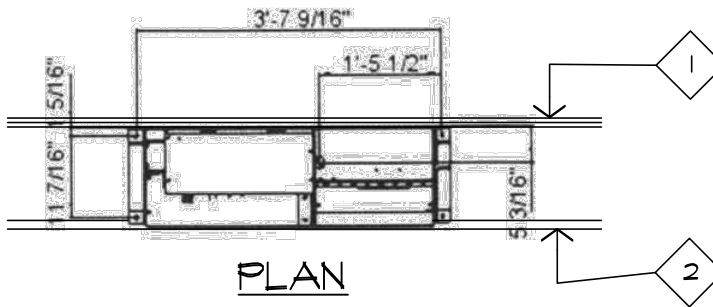

ELEVATOR CONTROLLER CONTROLLER WITH UPSTAND N.T.S.

ADDENDUM NO. 4
ATTACHMENT NO. 10

PAGE 2 OF 4
MAY 14, 2026

GENERAL NOTES:

- VERIFY DIMENSIONS WITH ELEVATOR MANUFACTURER.
- BASIS OF DESIGN IS OTIS ELEVATOR COMPANY'S GEN 3 CORE GEARLESS MACHINE, ROOMLESS ELEVATOR SYSTEM. OTHER GEARLESS ROOMLESS UNITS WILL BE CONSIDERED FOR PRIOR APPROVAL.



CARENCRO CITY HALL EXPANSION 2026

210 EAST ST. PETER STREET CARENCRO, LOUISIANA

Lynn Guidry
ARCHITECT

411 ARCENEUX ROAD CARENCRO LOUISIANA 70520
337.896.6695 email: lynn@lynnguidryarchitect.com